

SmokeGENIE

Theatrical Fog Generator

INSTRUCTION MANUAL

SmokeGENIE V1 +
SmokeGENIE remote V1
FCC ID: 2A35T-G0916

Distributed By:
Practical Magic & Innovation Co. Ltd.
9A Leapont Centre, Fotan, Hong Kong
Made in China

Date of Publication: Mar 2022



This device complies with part 15 of the FCC Rules. Operation is subject to the following two conditions: (1) This device may not cause harmful interference, and (2) this device must accept any interference received, including interference that may cause undesired operation.

TABLE OF CONTENTS

<i>About this Manual</i>	1
<i>Important Warnings</i>	1
<i>Quick Start Guide</i>	2
<i>List of Attachments</i>	3
<i>About the Machine</i>	4
<i>Atomizing Smoke Chamber</i>	5
<i>Operational Instructions</i>	6
<i>Machine Troubleshooting</i>	7
<i>Safety Information</i>	9

VIDEO TUTORIAL



FACEBOOK USER GROUP



ABOUT THIS MANUAL

This Manual provides instructions on how to use, store, and troubleshoot the SmokeGENIE and its accessories for making theatrical smoke. You may also watch our video tutorials. (SCAN QR CODES on the right)

USERS MUST READ ALL SAFETY INFORMATION IN THIS MANUAL before operating SmokeGENIE.

The SmokeGENIE is designed for creating visual effects for photography, filmmaking and stage theatre. It should NOT be used for ANY other unintended purposes.

DO NOT run SmokeGENIE on an empty tank. Always check level of fog liquid.

If you keep seeing “TIME OUT” on display, STOP the machine immediately and read page 7 of manual (troubleshooting).

QUICK START GUIDE

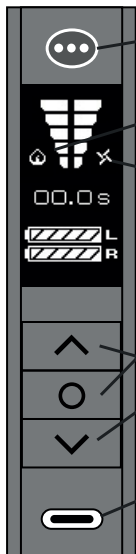

Step 1: RED BUTTON

Press once to check battery, then
Press 3 TIMES for ON/OFF

Step 2: SMOKE LEVEL

Level 1-3 are continuous modes,
level 4,5 are short bursts.

Step 3: WIND LEVEL

Changes the speed of the smoke.
Keep default setting at level 5.

TOGGLE BUTTON:

Toggle between SMOKE and
WIND level controls.

UP/DOWN BUTTON:

Use these buttons to change
power levels

USB-C CHARGING

Fast Charge ~3.5 hrs
DO NOT leave charging
overnight.

SMOKE Lv. 1, 2, 3



CONTINUOUS
MODE

Lv. 4, 5



BURST MODE:
will trigger
"Timeout"

DEFAULT SETTINGS for smoke effects:

HAZE:



3+5



HAZE FAN

FOG:



3+5



JET TIP

DRYICE:



3+2



LIQUID
NOZZLE

Turn OFF the
SmokeGENIE
before storage.



Smoke is HOT.
Do NOT point
at the eyes!



HOT CHAMBER.
Do not touch
When Cap is PINK.



NOT A TOY.
For Professional
Use only.



AVOID any
SENSITIVE Smoke
Detectors nearby.



FOR VISUAL EFFECTS
Only. Do NOT Directly
ingest smoke.



LIST OF ATTACHMENTS FOR SMOKEGENIE

1. Atomizing Smoke Chamber
2. Silicone Extension Tube - 30cm
3. Precision Nozzle (Long)
4. Precision Nozzle (short)
5. Precision Nozzle (60 Degree turn)
6. High Pressure Jet-Tip
7. 1/4 inch Universal Mount Adapter
8. Liquid Nozzle
9. Wireless Remote
– requires one 23A 12V battery (NOT INCLUDED)

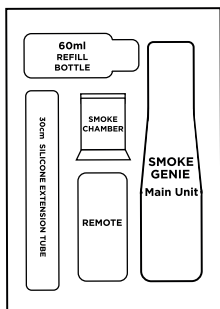

STARTER KIT

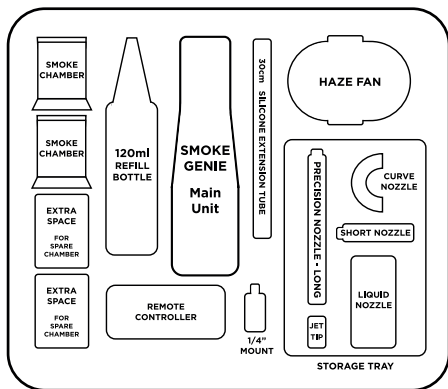

PROFESSIONAL KIT

ABOUT THE MACHINE

SMOKE OUTPUT

DO NOT POINT directly at people.

CHAMBER DISPLAY AREA

To check for level of fog liquid left. Must refill when less than 1/3 liquid is left.

POWER BUTTON

Press once to check battery, then Press 3 times to toggle on/off

LCD DISPLAY



POWER LEVEL

Left: smoke level (1-5)
Right: wind level (1-5)

TIMER

for smoke output

BATTERY LEVEL

Left and Right batteries

UP BUTTON

Increase the power level

TOGGLE BUTTON

Toggle between modes:
Smoke / Wind Level

DOWN BUTTON

lower the power level

USB-C PORT

For Fast Charging
(Won't generate smoke while charging)

HEAT SHIELD

magnetically attached

SMOKE BUTTON

Press to make smoke

BATTERY COMPARTMENT

Fits two 18650-type batteries
(NOT INCLUDED)

OTHER ITEMS IN THE BOX:

- REMOTE (433mHz RF)
- CLOUD FORMULA Fog liquid (VG + PG)
- Attachment and Accessories

ATOMIZING SMOKE CHAMBER

AIRTIGHT STORAGE CAPSULES

REMOVE the Chamber from the air-sealed capsule by removing the bottom cap, and lifting the chamber out.

ALWAYS keep chambers in air-sealed capsules when in storage.

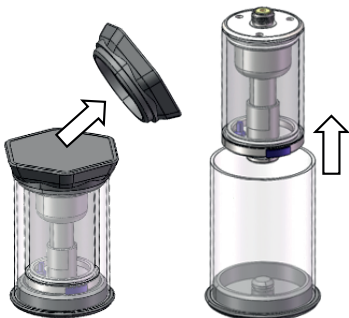

INSTALLING THE CHAMBER

ROTATE Clockwise to screw the chamber on to the Genie. DO NOT OVER-TIGHTEN the chamber.

When turned on, the display will show "TANK CONNECTED" when chamber is detected. Then tighten it for one more HALF turn, this is optimal tightness.

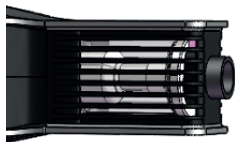
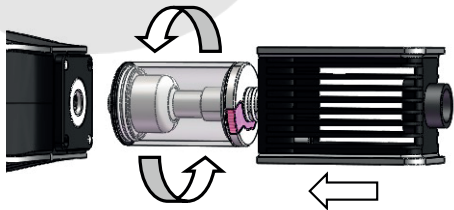

MAGNETIC HEAT SHIELD

Always keep the Heat Shield on. Do not hold the machine by the heat shield area.



WARNING!

Chamber gets hot During and After smoke generation. Can cause burns if touched.

HEAT SENSITIVE SILICONE TAB

Gently peel back to refill fog Liquid. When chamber goes over 60 DEGREES CELCIUS, The cap will turn PINK to warn against burning hazard.



WARNING!

DO NOT TOUCH chamber when cap turns PINK.

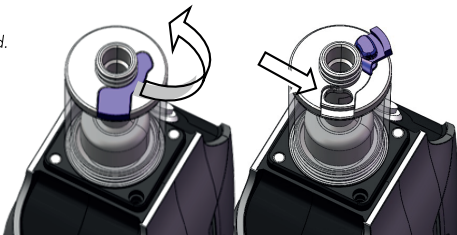

OPERATIONAL INSTRUCTIONS

The SmokeGENIE is designed to be easy to use with minimal maintenance. With a simple 3-step setup, it will be ready to serve you with a long service time.

SET-UP

1. Lift up the Silicone cap at the top of the Smoke Chamber, and fill it with the supplied "Cloud formula" Fog Liquid supplied with the package.

IMPORTANT: When Opening a BRAND NEW Chamber, please fill the chamber to full, close the Silicone Tab, and leave it to rest for 5 minutes. This is to properly soak the heating unit with fog liquid for the first time.

2. Screw the Chamber on to the top of the SmokeGENIE main unit.
3. Insert the Batteries (two 18650s for GENIE, one 23A battery for remote).
And now you are all set!

OPERATION

1. Press the RED BUTTON once to check battery, then 3 times to switch the machine ON. Press the same button 3 times to power off.
2. Adjust the power and wind levels using the toggle buttons.
3. Press the SILVER BUTTON / Remote button to create smoke.
4. Auto-Power off - The Screen will turn off after 10 seconds, and the machine will turn off if left idle for 120 minutes.

BATTERY

1. Charging – the SmokeGENIE is capable of 3.5 hours fast-charging using the USB-C charging port. (Battery level is displayed on the LED screen. We recommend charging when the battery is below 2 bars.)
2. Battery Replacement – Simply lift open the magnetic battery cover and replace batteries. The SmokeGENIE uses two FLAT TOP, UNPROTECTED type 18650 Batteries. Recommend specs are: 3.5v or up, 10A or up.

FOG LIQUID REFILL

1. The liquid level is visible at all times via looking through the heat shield. Refill whenever the liquid level drops below 1/3.
2. Lift up the Silicone cap on top of the smoke chamber and refill it using the cloud formula supplied with the package.

MAINTENANCE

1. Unscrew the old chamber
2. Screw on new chamber (follow set-up instruction if opening a brand new chamber)

MACHINE TROUBLESHOOTING

Q1: Why am I seeing "TIME OUT" on the machine?

A: "TIME OUT" means the heating unit inside the chamber is under fuelled, and may cause overheating if it continues to operate. This is part of our protection system to keep the machine safe and durable.

What is causing this?

- 1) Smoke Levels 4 and 5 are designed for intense short bursts, which will cause liquid to dry out faster. This is completely normal, you just need to wait for the message to disappear after 3 seconds, then you can start again. If you want to make longer pulses of over 10 seconds, we suggest using smoke levels 1, 2 or 3.

If you continue to see "TIME OUT" message, please see below:

- 2) Check the oil level of the tank. Machine will keep showing "TIME OUT" when fog liquid is almost out.
- 3) Make sure the machine is not operating upside down. Due to the design of the chamber, it can only operation upside down for a short period of time and needs to be refuel between pulses. If you need your smoke to flow downward, simply use our accessories and nozzles to guide the smoke downward.
- 4) In extreme cold temperatures (Below 10 Degrees Celsius), you might still trigger TIME OUT in level 3, because of the liquid being less "runny" in the cold. In this case, simply warm up the machine by letting the machine run a few times (30-60 seconds) until the chamber becomes warm.

If all measures above are observed (operating in smoke level 1-3, tank is full, not operating upside down and in normal atmospheric temperature), but still experiencing "TIME OUT" constantly, this means the chamber is wearing out. You may still use this chamber until the display says "TANK FAULTY", but the performance of the smoke chamber may be compromised.

Q2: Why am I seeing "TANK FAULTY"?

A: This means your tank is damaged and should be replaced. Please follow the instruction on "OPERATION INSTRUCTION" to replace the smoke chamber. If this happened to a brand-new tank, please contact customer support and we will get this sorted out for you.

Q3: When should I permanently replace my Smoke Chamber?

A: There are 4 signs to look for that hints at a damaged chamber:

- 1) When the machine displays "TANK FAULTY" when chamber is installed.
- 2) When the Chamber starts to produce an unpleasant burning smell (Usually after 30-50 full day shooting sessions)
- 3) Machine keep prompting "TIME OUT" warning during normal operation
- 4) When the smoke becomes very pale even in high smoke levels.

In these 4 cases, it is highly likely that the chamber is damaged, or has reached the end of its lifecycle. Please replace a new chamber.

Q4: Why is my SmokeGENIE spitting out excessive oil during operation?

A: It means the heating unit inside the chamber is oversoaked with fog liquid. This does NOT damage the condition of the chamber, and here is how to fix it:

Place a dry napkin on the table, and place the chamber upside down on a napkin for 1 minute. Let the excessive oil drain out from the mouth of the chamber, then tap it a few times to remove any droplets. Screw the chamber back on to test if there are still any remaining droplets.

Q5: What to do if I broke the glass of the Chamber while it's installed?

A: You should immediately remove the batteries and carefully remove the chamber.

- 1) Use a pair of pliers to help.
- 2) Take your machine to a sink, and tilt it upside down to carefully remove the heat shield (if it's still there). Completely drain out the fog liquid. AVOID letting the liquid drip into the SmokeGENIE.
- 3) Carefully remove any broken glass pieces. Then, use the pliers to slowly unscrew the broken chamber.
- 4) Once the chamber is removed, wipe the SmokeGENIE clean from any liquid.

You can either carefully dispose the chamber, or you can return your chamber via our refurbishment program and purchase a new chamber with discount. This program is currently offered to a limited number of countries, please contact your local dealer to see if this is available to your region.

Q6: What does my SmokeGENIE warranty cover?

Our 1-year warranty for the SmokeGENIE is eligible to all users who bought from our authorised dealers. The warranty covers any defect due to manufacturing; any issues caused by FIRE, WATER or PHYSICAL damage is NOT COVERED.

During the warranty period, users can contact their local dealer or email us at INFO@PMIGEAR.com for direct machine support.

This warranty covers the SmokeGENIE main unit and its accessories. The chamber is considered as a consumable, and is therefore NOT covered by this warranty.

SAFETY INFORMATION

We have designed the SmokeGENIE to be as user-friendly as possible. However, SmokeGENIE runs on high-drain, high current batteries, and emits strong HEAT during normal operation. Therefore users MUST note the following safety measures in mind, to ensure the safety of everyone on set.

1. STOP using the machine if you continue to experience a "TIMEOUT" warning. Refer to the troubleshooting section of this manual.
2. DO NOT operate SmokeGENIE on an empty chamber. Always check the liquid level before each operation, make sure you are not running on an empty tank.
3. AVOID pointing the machine downward. While the chamber can produce short bursts of smoke in all orientations, tilting the machine downward may affect the flow of the liquid. If you want to make smoke continuously, keep the machine pointing at least horizontally, or use an adapter to point the smoke downward.
4. DO NOT point the smoke directly at people! The smoke right out of the chamber is hot, and occasionally, hot droplets of liquid may escape when machine have operated for a long period. Keep a minimum distance of 3m away from the nozzle.
5. DO NOT touch the chamber during operation! The Chamber is HOT during smoke generation.
6. DO NOT touch the chamber when the silicone cap turns PINK. The Silicone cap is coloured with heat-sensitive paint that turns PINK when the chamber is hot. Wait until the cap turns back to dark purple before removing the chamber.
7. DO NOT operate the machine near flammable, combustible materials, or materials that s is extra sensitive to heat. Keep a minimum distance of 50cm.
8. DO NOT point the smoke near source of ignition, like fires or sparks. Keep a minimum distance of 50cm.
9. DO NOT use any third-party fog liquids with SmokeGENIE. The PMI cloud formula is designed to optimize the machine's performance and durability. Due to the unique design of our chamber, other fog liquids will NOT WORK and may cause undesired effects. We are NOT liable for any damage to the machine when using third-party fog liquid in the SmokeGENIE.
10. DO NOT inhale the smoke directly. While our formula is non-toxic, it is not made for direct inhalation and the high temperatures may cause burns.
11. DO NOT let children play with SmokeGENIE without adult guidance. As user friendly as it is, SmokeGENIE is NOT a toy and could be a fire hazard for children if not handled properly.
12. DO NOT operate SmokeGENIE near smoke detectors. Due to the nature of smoke generation, the smoke made by SmokeGENIE will trigger smoke detectors that are designed to detect small particles.